

# DNG 32-320 ISO 15552



Standards-based cylinders to ISO15552 ,ISO 6431

The piston seal is composed of two Y-shape one way seal structure which has compensation function, long service life and low start-up pressure

Robust tie rod design

With adjustable end-position cushioning at both ends

Double-acting

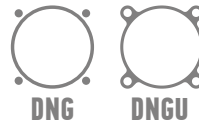

## TECHNICAL DATA

BORE[Φ]	32	40	50	63	80	100	125	160	200	250	320
<b>Pneumatic connection</b>	G1/8"	G1/4"	G1/4"	G3/8"	G3/8"	G1/2"	G1/2"	G3/4"	G3/4"	G1"	G1"
<b>Piston rod thread</b>	M10×1.25	M12×1.25	M16×1.5	M16×1.5	M20×1.5	M20×1.5	M27×2	M36×2	M36×2	M42×2	M48×2
<b>Cushioning</b>	Adjustable at both ends										
<b>Cushioning length[mm]</b>	19	21	23	23	30	30	40	40	50	50	50
<b>Operating temperature</b>	-20-80°C										
<b>Operating pressure</b>	12 bar										
<b>Operating medium</b>	Filtered compressed air, with or without lubrication										
<b>Version</b>	Single acting or Double acting										
<b>Type of mounting</b>	Via accessories										
<b>Mounting position</b>	Any										

1 bar=0.1MPa=14.5PSI

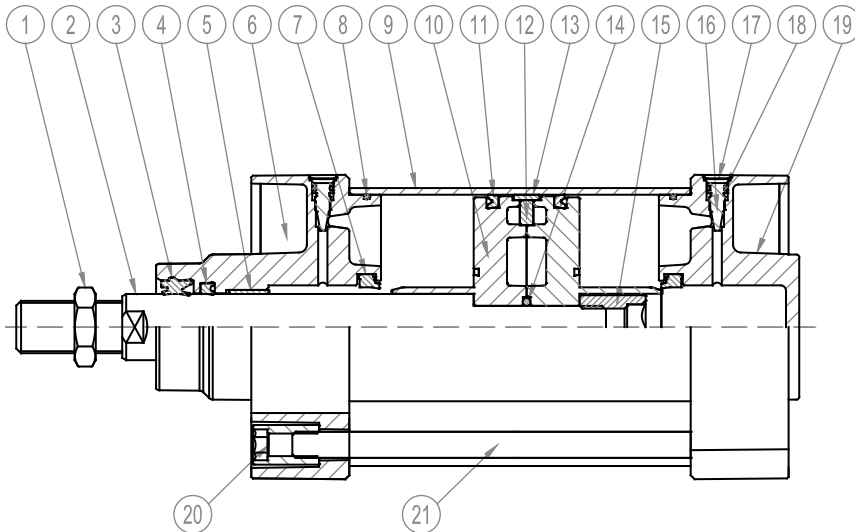

1	Nut,Piston rod	Carbon steel
2	Piston rod	C45 chrome-plated steel
3	Wiper seal	PU
4	Wiper seal	NBR
5	Oil bearing	Steel
6	Front cover	Die cast aluminium
7	Cushioning seal	NBR
8	O-ring,Front cover	NBR
9	Tube	Anodized aluminium
10	Piston	Die cast aluminium
11	Piston seal	NBR
12	Magnet	Ferrite
13	Wear Ring	POM
14	O-ring,Piston rod	NBR
15	Piston rod lock nut	Carbon steel
16	Cushion adjustment screw	Brass
17	Snap ring,Cushion screw	Spring steel
18	O-ring,Cushion screw	NBR
19	End Cover	Die cast aluminium
20	Tie-rod nut	Nickel-plated steel
21	Tie rod	Nickel-plated steel

The cover of Ø32-100 only have 3 Wiper seal.Besides, they use Snap ring for the Cushion screw  
The cover of Ø125-320 have 3 4 Wiper seal,they use inner snap ring for the Cushion screw

## KEY CODE

**DNG** **D** - **50** **X** **50** - **25** - **S** - **SA** - **P** - **2** **4** - **LB** - **I**

DNG	D	50	50	25	S	SA	P
SERIES	TYPE	BORE	STROKE[mm]	ADJUSTABLE STROKE	MAGNETIC	VERSION	THREAD TYPE
DNG=With tie rod	Blank=Standard	32-40-50-63-80-100-125-160-200-250-320	As request	As request	Blank=Without magnet	SA= Single acting	P= PT Thread
DNGU=Without tie rod	D=Double rod type				S=With magnet	DA= Double acting	N= NPT Thread G= G Thread

2	4	LB	I
PISTON ROD MATERIAL	TIE ROD MATERIAL	MOUNTING TYPE	CONNECTOR TYPE
Blank=Carbon steel 2=316 Stainless steel	Blank=Carbon steel 4=316 Stainless steel	Blank=Without accessory LB=Angle bracket FA=Flange CA=Male clevis CB=Female clevis LNG=Square hinge	Blank=Without accessory I=I JOINT Y=Y JOINT U=Rod eye joint F=Floating joint

PS: High temperature seals available upon request

**DNG Standard Type**

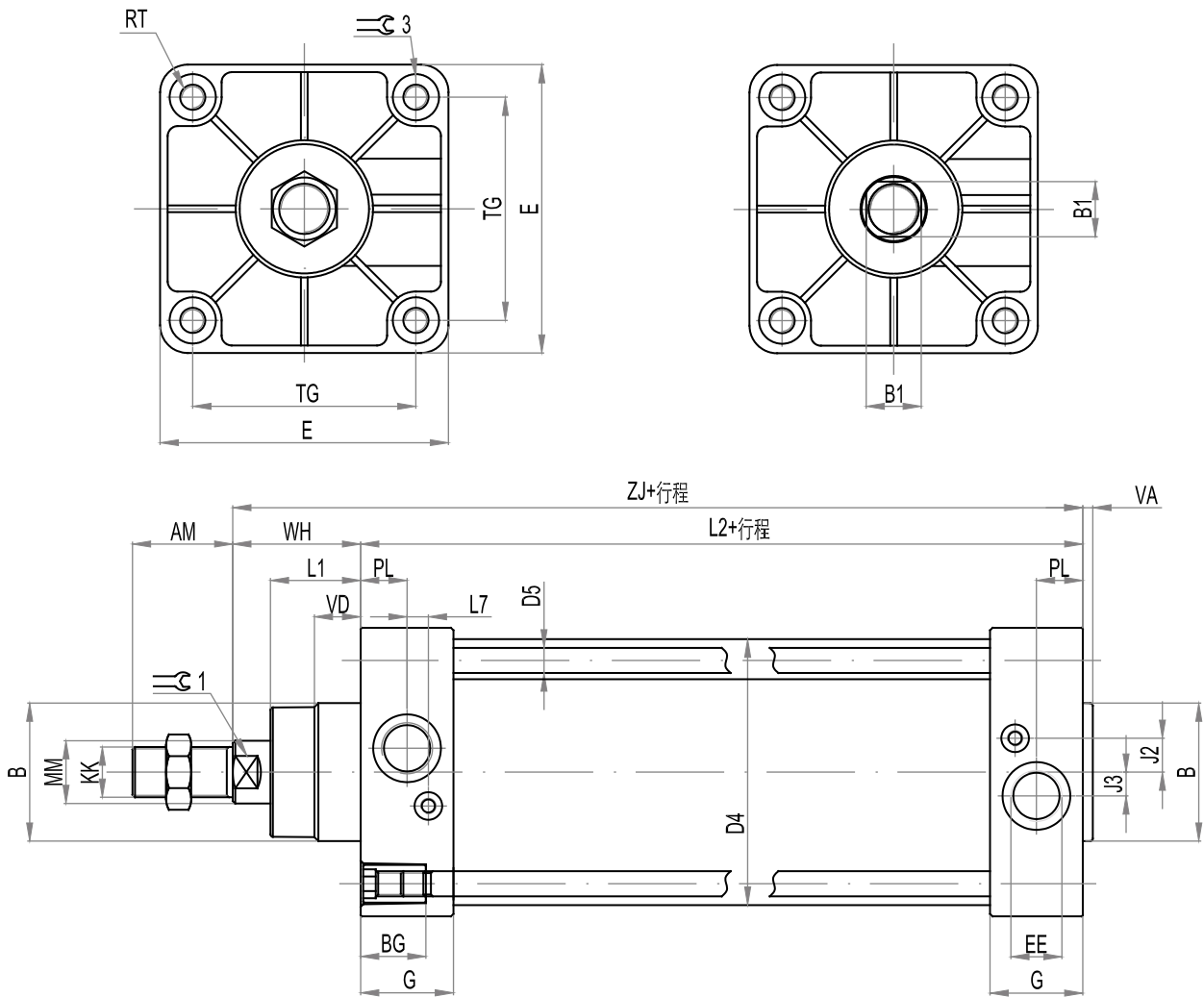



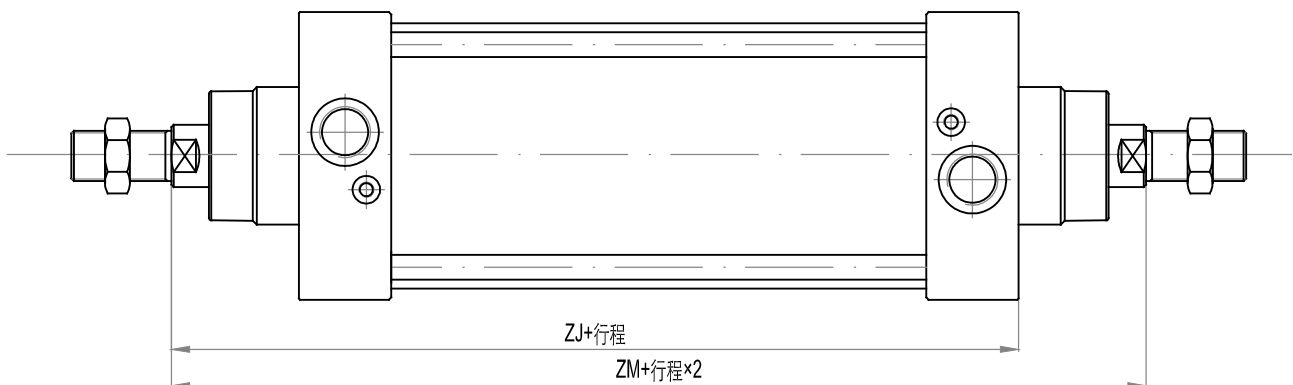

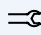
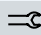





**DNGD Double rod type**



Φ [MM]	32	40	50	63	80	100	125	160	200	250	320
<b>AM</b>	22	24	32	32	40	40	54	72	72	84	96
<b>B</b>	30	35	40	45	45	55	60	65	75	90	110
<b>B1</b>	17	17	23	23	26	26	41	55	55	64	72
<b>B6</b>	22.5	22.5	22.5	23	26	26	32.5	36	36	40	45
<b>D4(Φ)</b>	37	45	55	68	86	106	133	170	210	262	335
<b>D5(Φ)</b>	5.1	5.1	6.95	6.95	8.25	8.25	10.8	14.35	14.35	20	22
<b>E</b>	47	53	65	75	95	115	140	180	220	270	350
<b>EE</b>	G1/8"	G1/4"	G1/4"	G3/8"	G3/8"	G1/2"	G1/2"	G3/4"	G3/4"	G1"	G1"
<b>G</b>	27.5	32	31	33	33	37	46	50	50	60	65
<b>J2</b>	6	8.5	9.5	11.5	13.5	13.5	14	20	20	25	30
<b>J3</b>	5.5	6	7.5	7.5	9	9.5	14	15	15	25	30
<b>KK</b>	M10×1.25	M12×1.25	M16×1.5	M16×1.5	M20×1.5	M20×1.5	M27×2	M36×2	M36×2	M42×2	M48×2
<b>L1</b>	19	21	27	27	33	36	40	58	65	75	90
<b>L2</b>	94	105	106	121	128	138	160	180	180	200	220
<b>L7</b>	6	7.5	6.5	7.5	7.5	8.5	12	12	12	10	15
<b>MM</b>	12	16	20	20	25	25	32	40	40	50	63
<b>PL</b>	13	17	15.5	16.5	16.5	18.5	23	25	25	30	30
<b>RT</b>	M6	M6	M8	M8	M10	M10	M12	M16	M16	M20	M24
<b>TG</b>	32.5	38	46.5	56.5	72	89	110	140	175	220	270
<b>VA</b>	3	3.5	3.5	4	4	4	4	4	5	8	10
<b>VD</b>	8	10	10	12	15	15	10	10	25	25	25
<b>WH</b>	26	30	37	37	46	51	65	80	95	105	120
<b>ZJ</b>	120	135	143	158	174	189	225	260	275	305	340
<b>ZM</b>	146	165	180	195	220	240	290	340	370	410	460
	10	13	17	17	22	22	27	36	36	46	55
	6	6	8	8	-	-	-	-	-	-	-

## MOUNTING ATTACHMENTS AND ACCESSORIES

Φ	LB	FA/FB	CA	CB	LNG	SNCS	I	Y	U	PIN
										
<b>32</b>	●	●	●	●	●	●	●	●	●	●
<b>40</b>	●	●	●	●	●	●	●	●	●	●
<b>50</b>	●	●	●	●	●	●	●	●	●	●
<b>63</b>	●	●	●	●	●	●	●	●	●	●
<b>80</b>	●	●	●	●	●	●	●	●	●	●
<b>100</b>	●	●	●	●	●	●	●	●	●	●
<b>125</b>	●	●	●	●	●	●	●	●	●	●
<b>160</b>	●	●	●	●	●	●	●	●	●	●
<b>200</b>	●	●	●	●	●	●	●	●	●	●
<b>250</b>	●	●	●	●	●	●	●	●	●	●
<b>320</b>	●	●	●	●	●	●	●	●	●	●

More are available in accessories. Cover kits and service kits are available